

Eaves cutter type TS 1

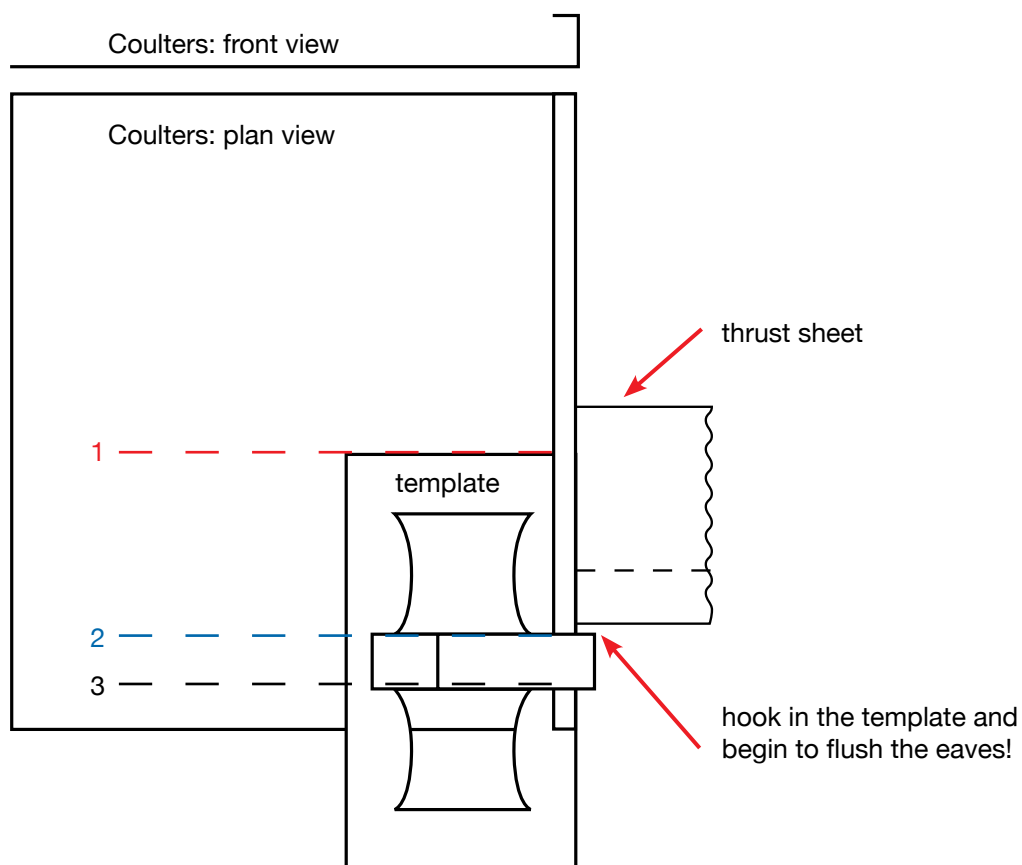

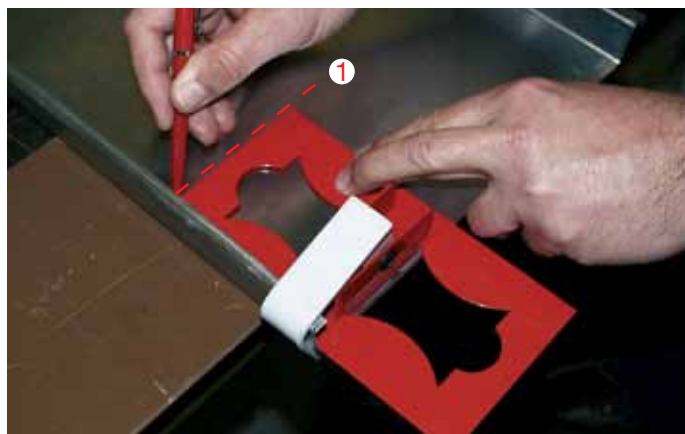

- 1. Signs line = Equipment line approach for the eaves cutter
- 2. Signs line = lateral ridge eaves
- 3. Signs line = band section (at supernatant)



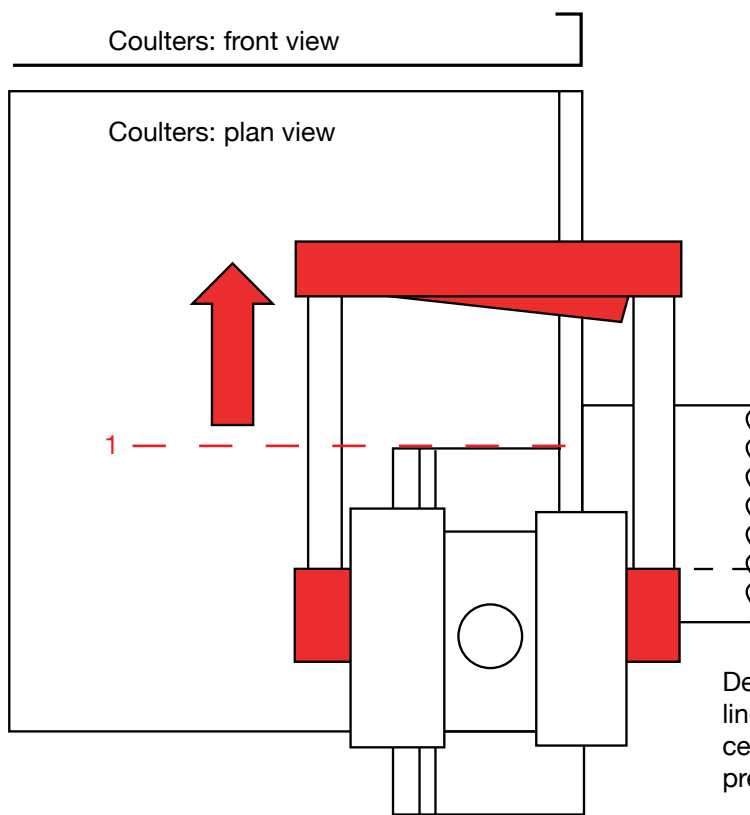

Device to the signs of the start line. **Cutting bow** from the center position to the fold by pressing the arrow.

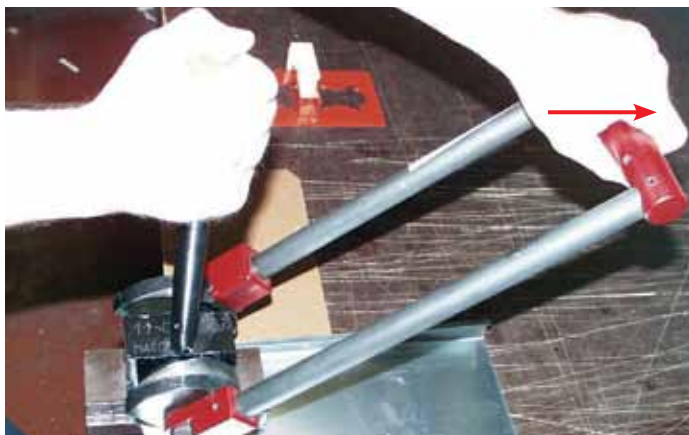

Coulters: front view

Coulters: plan view

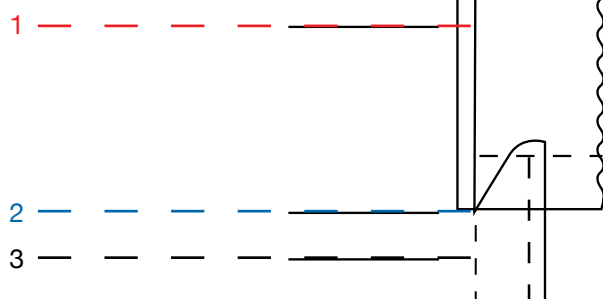

Nick press flat and smooth



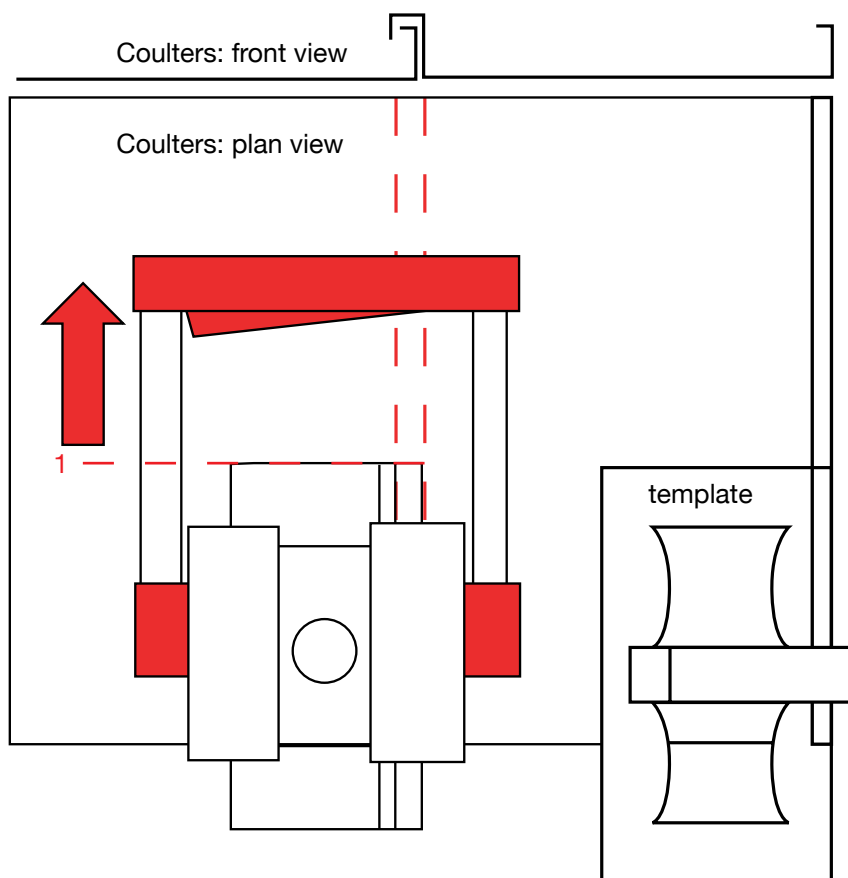

Rotate MASC eaves cutter by 180°, Use device-side for overlap; Overlap slightly raise, again start showing signs of the line (see pictures below).

Cutting bow from the center position out to the fold in the arrow direction by pressing. Move back the cutting bow for one locking and cut in arrow direction.

In a eaves projection larger than 2.5 cm, repeat in 15 mm intervals to line drawing a cutting process by means of several cuts.



Rotate MASC eaves cutter by 180°, lift the cover slightly, and start eaves cutter again at the line.



Cutting bow from the center position out to the fold in the arrow direction by pressing.

Eaves cutter type TS 1



Reset the cutter lever to cut through a lock and continue in the arrow direction (see below).



Throw out the waste piece from the overlap.

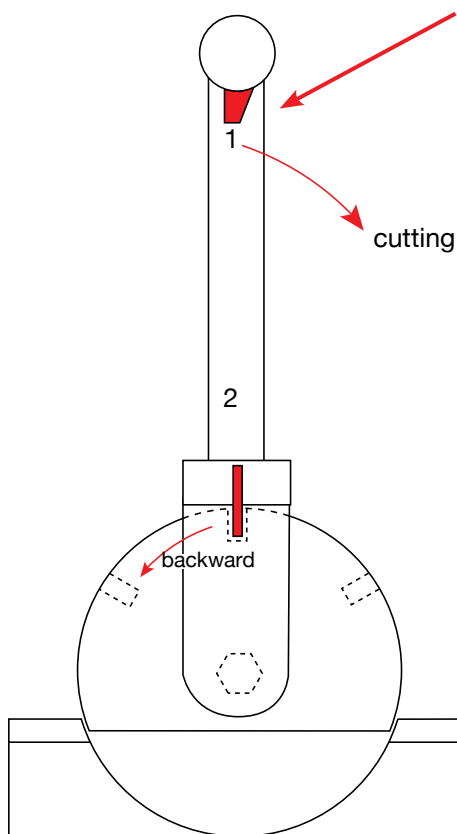
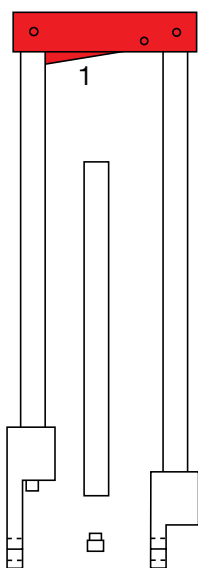

1. By pressing the locking lever to solve the locking pin.

cutting direction

2. The cutter lever in the desired direction and press into place in the new locking position can be.

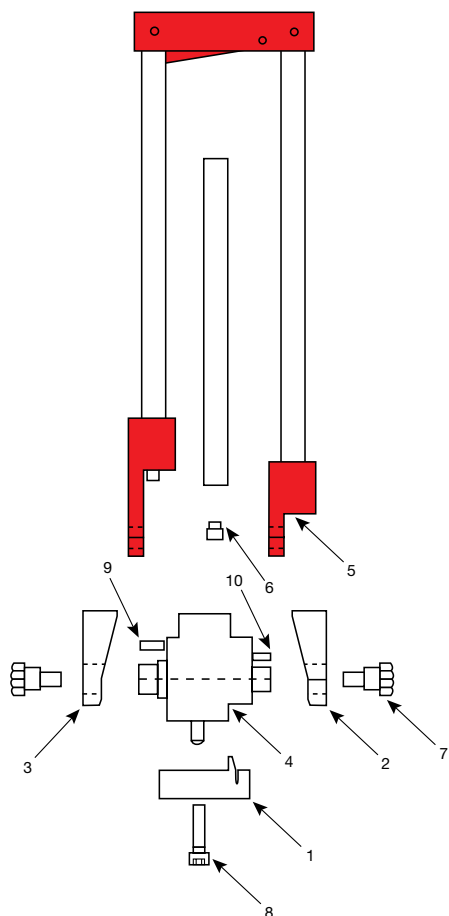

Nr.	Piece	Description
1	1	cutting board
2	1	cutting wheel small (coverage)
3	1	cutting wheel large (shortfall)
4	1	body
5	1	cutting lever
6	1	handle
7	2	screw
8	2	cylinder screw
9	1	feather
10	1	feather

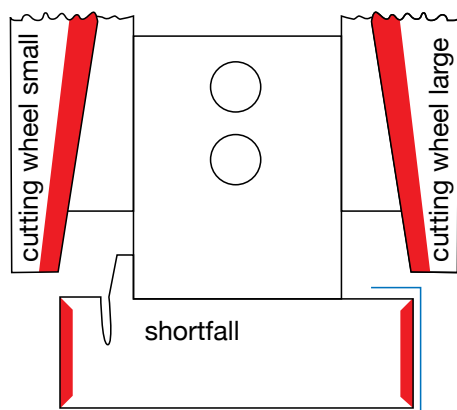

Red area = cutting surface, spray from time to time with MASC-Schneidfix. Repeat this process for aluminum sheets often.

Avoid dry sections to prevent out-breaks of the cutting wheel.

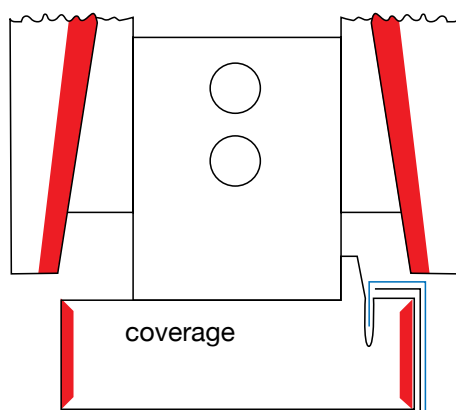

Reasonable complementary tools for **Eaves cutter** type TS 1

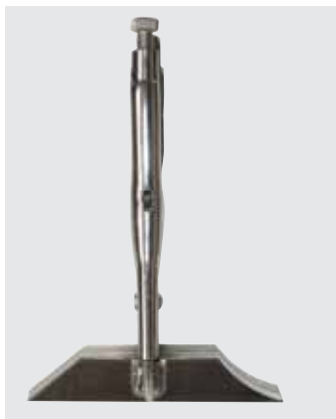

MASC grip-forceps to ramble
SCHGZ



MASC Vise-grip wrench
SGZS



MASC Vise-grip wrench
SGZSK